

AIRIUS MOUNTING GUIDELINES - OPAL SERIES - Model EC

PLUG NOT SUPPLIED

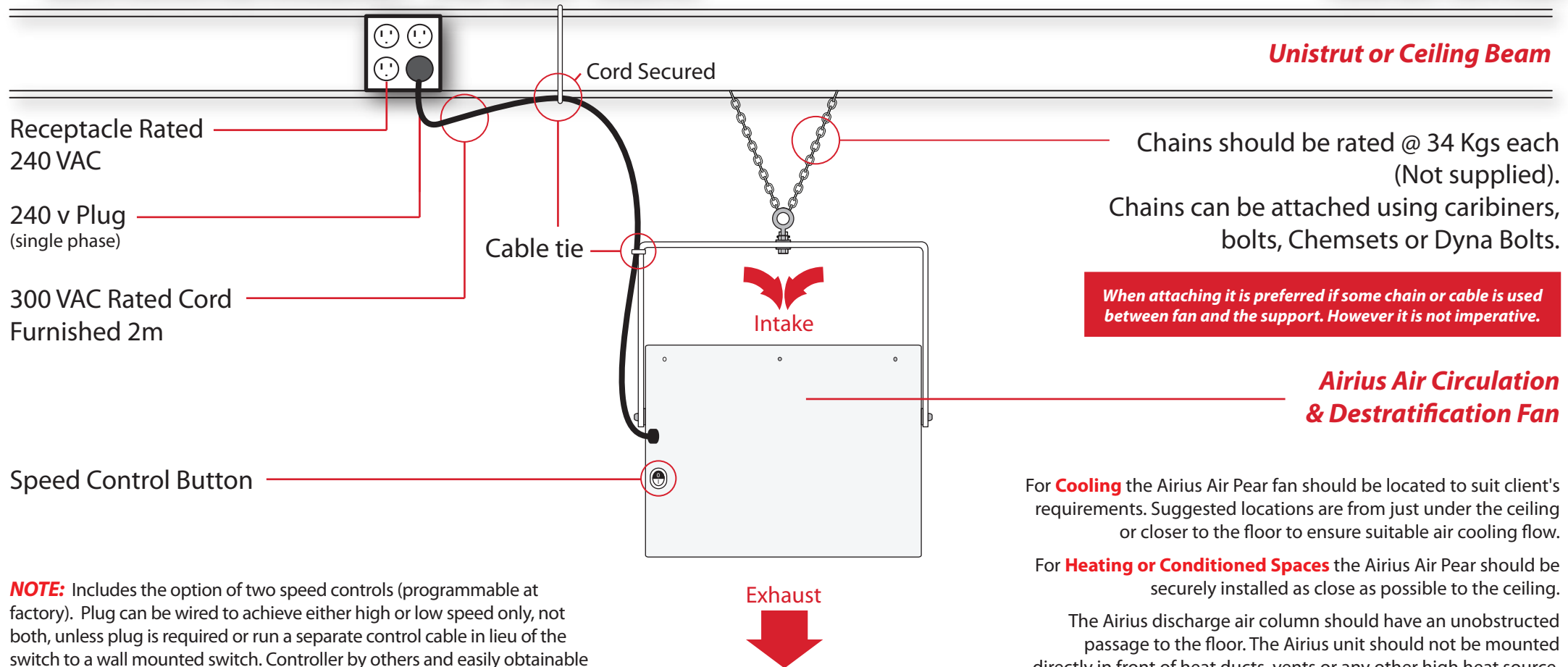

Unistrut or Ceiling Beam

Chains should be rated @ 34 Kgs each (Not supplied). Chains can be attached using caribiners, bolts, Chemsets or Dyna Bolts.

When attaching it is preferred if some chain or cable is used between fan and the support. However it is not imperative.

Airius Air Circulation & Destratification Fan

For **Cooling** the Airius Air Pear fan should be located to suit client's requirements. Suggested locations are from just under the ceiling or closer to the floor to ensure suitable air cooling flow.

For **Heating or Conditioned Spaces** the Airius Air Pear should be securely installed as close as possible to the ceiling.

The Airius discharge air column should have an unobstructed passage to the floor. The Airius unit should not be mounted directly in front of heat ducts, vents or any other high heat source.

The units must not be located closer than 3 metres to return air ducts in conditioned spaces.

NOTE: Includes the option of two speed controls (programmable at factory). Plug can be wired to achieve either high or low speed only, not both, unless plug is required or run a separate control cable in lieu of the switch to a wall mounted switch. Controller by others and easily obtainable at any electrical store. The speeds can be factory programmed if needed.

AIRIUS MOUNTING GUIDELINES - OPAL SERIES - Model EC (Angled)

PLUG NOT SUPPLIED

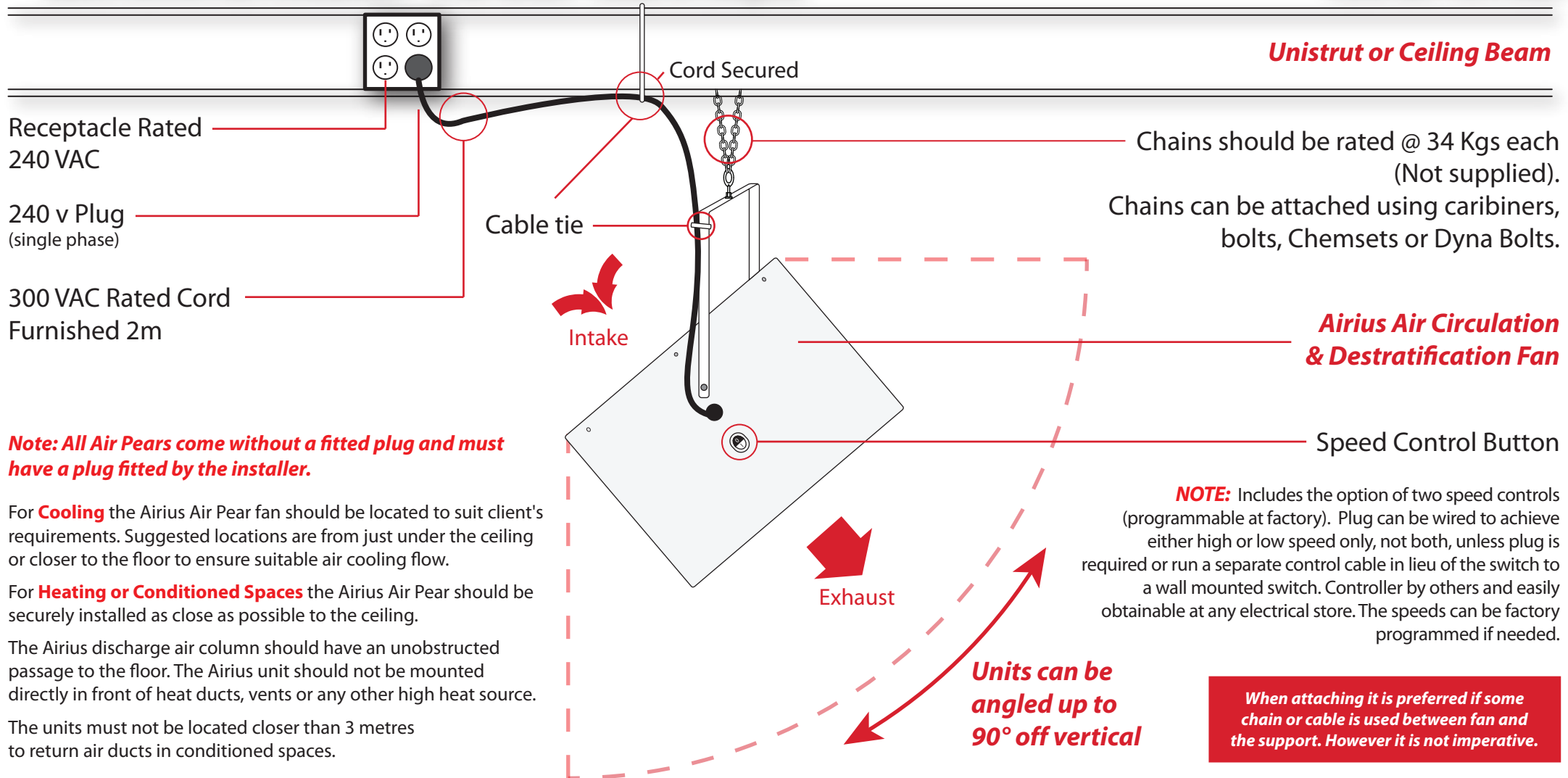

Note: All Air Pears come without a fitted plug and must have a plug fitted by the installer.

For **Cooling** the Airius Air Pear fan should be located to suit client's requirements. Suggested locations are from just under the ceiling or closer to the floor to ensure suitable air cooling flow.

For **Heating or Conditioned Spaces** the Airius Air Pear should be securely installed as close as possible to the ceiling.

The Airius discharge air column should have an unobstructed passage to the floor. The Airius unit should not be mounted directly in front of heat ducts, vents or any other high heat source.

The units must not be located closer than 3 metres to return air ducts in conditioned spaces.

AIRIUS MOUNTING GUIDELINES - OPAL SERIES - Model EC (Wall Mounted)

PLUG NOT SUPPLIED

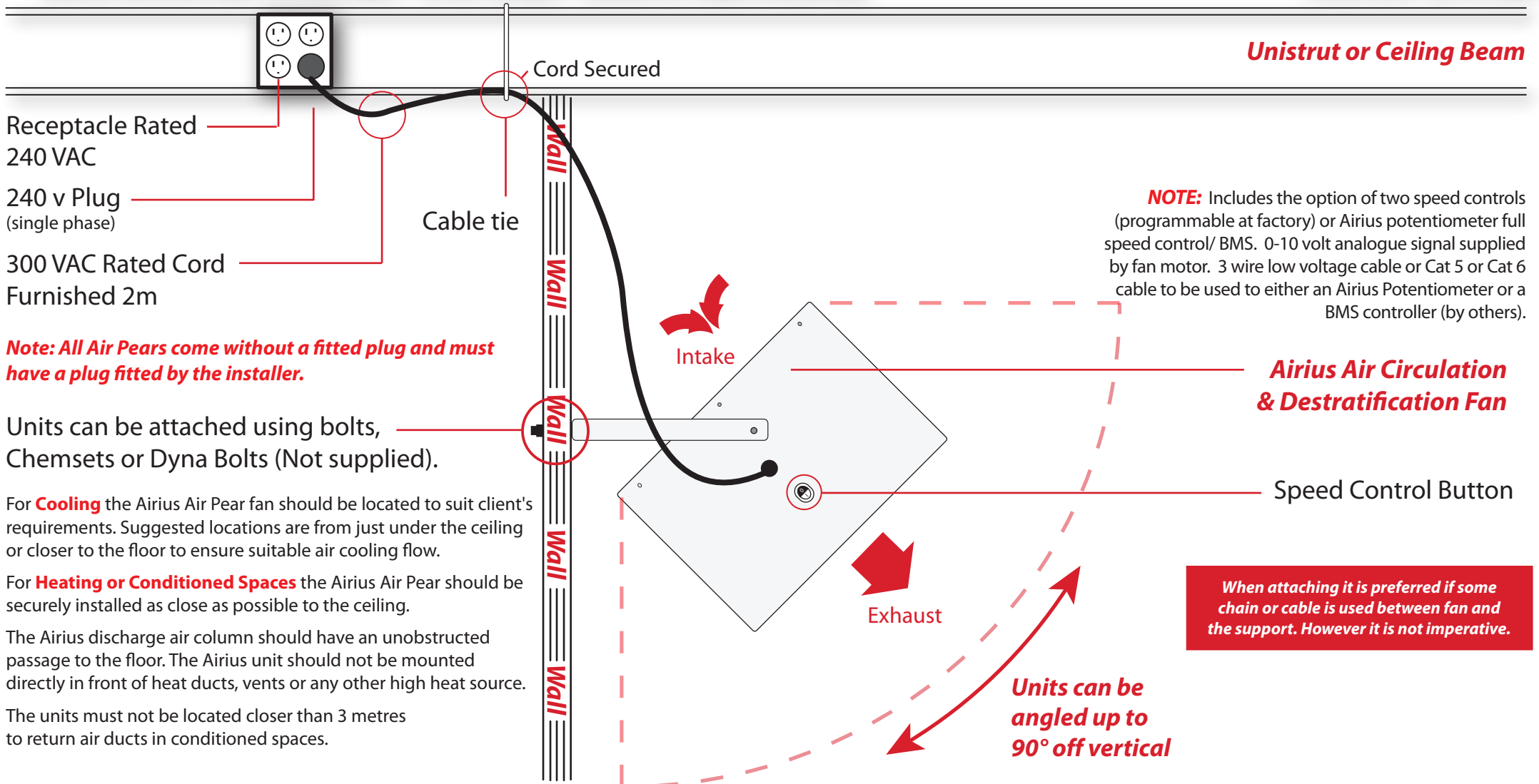

Unistrut or Ceiling Beam

Receptacle Rated
240 VAC

240 v Plug
(single phase)

300 VAC Rated Cord
Furnished 2m

Note: All Air Pears come without a fitted plug and must have a plug fitted by the installer.

Units can be attached using bolts, Chemsets or Dyna Bolts (Not supplied).

For **Cooling** the Airius Air Pear fan should be located to suit client's requirements. Suggested locations are from just under the ceiling or closer to the floor to ensure suitable air cooling flow.

For **Heating or Conditioned Spaces** the Airius Air Pear should be securely installed as close as possible to the ceiling.

The Airius discharge air column should have an unobstructed passage to the floor. The Airius unit should not be mounted directly in front of heat ducts, vents or any other high heat source.

The units must not be located closer than 3 metres to return air ducts in conditioned spaces.

NOTE: Includes the option of two speed controls (programmable at factory) or Airius potentiometer full speed control/ BMS. 0-10 volt analogue signal supplied by fan motor. 3 wire low voltage cable or Cat 5 or Cat 6 cable to be used to either an Airius Potentiometer or a BMS controller (by others).

Airius Air Circulation & De-stratification Fan

Speed Control Button

When attaching it is preferred if some chain or cable is used between fan and the support. However it is not imperative.

Units can be angled up to 90° off vertical